



Darwin Lake Ribber Cottage

3 Bedrooms
Sleeps 7 guests
(2 additional guests possible on request)

Ribber Cottage takes up the end spot in a quiet block of 3 cottages, overlooking the beautiful shores of Darwin Lake.

With 3 spacious bedrooms, this cottage sleeps up to 7 guests; it can also be booked with Kedleston Cottage and Hardwick Cottage to accommodate larger groups. Ribber Cottage features a spacious kitchen/dining area seating 8, comfortable lounge, and fully fitted kitchen, and is an excellent choice for get togethers, thanks to its large 'family bedroom' with 1 double bed and 1 single bed. Ribber Cottage is also ideal for warm weather getaways, as the double dining room doors can be opened to really maximise the living space. It also features a patio with garden furniture and BBQ, overlooking Darwin Lake.



Prices are inclusive of linen, towels and electricity.

Riber Cottage

3 Bedrooms. Sleeps 7 guests
(2 additional guests possible on request)

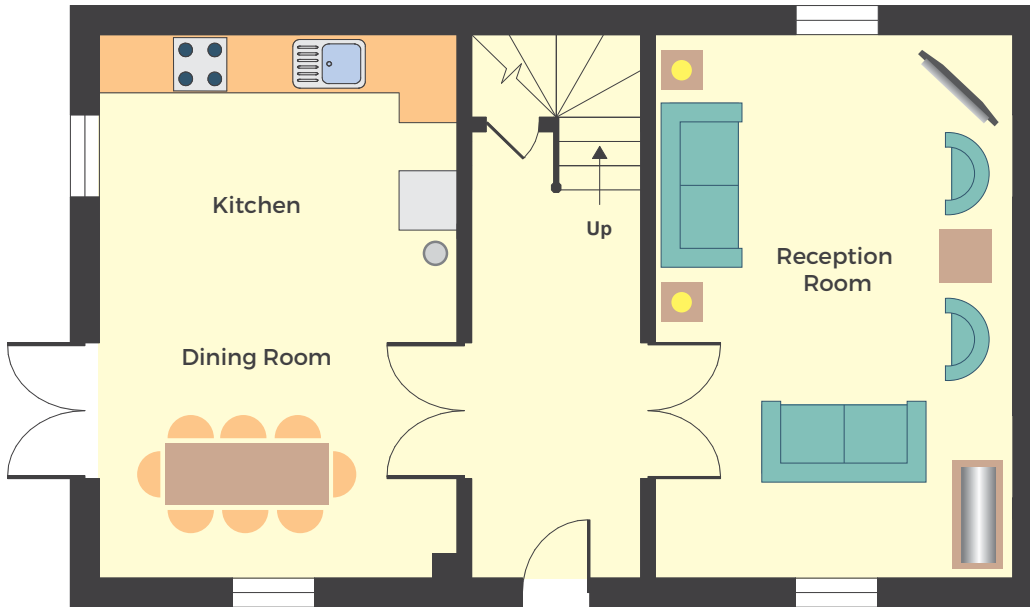

Ground floor

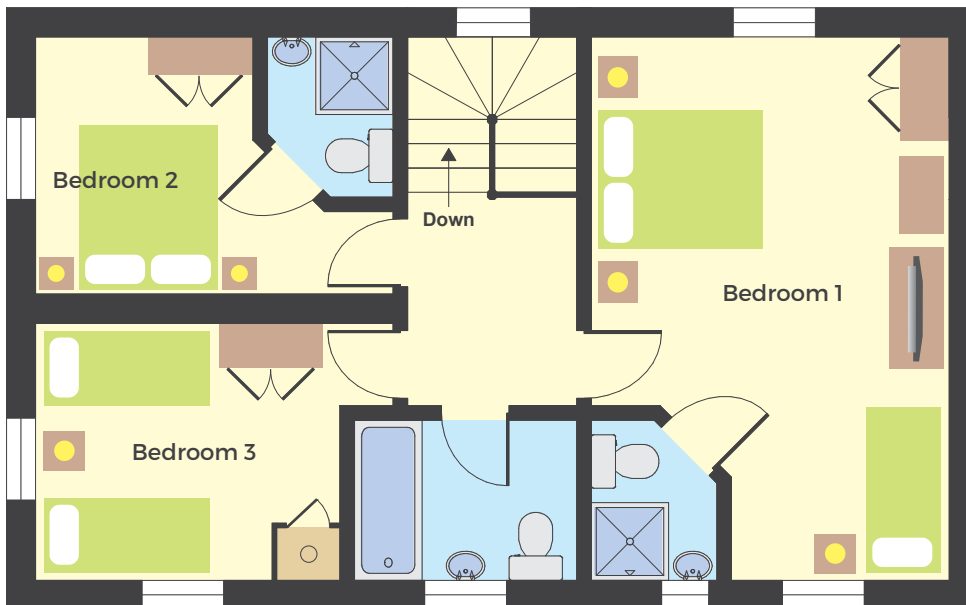

First floor

Site plan



Local amenities

The cottages at Darwin Lake make an excellent base for exploring the local area, which has a wide variety of activities, sights, and attractions to offer visitors of all ages. These include:

- Family-friendly theme parks including Alton Towers; Gulliver's Kingdom is just 5 miles away
- The historic market towns of Ashbourne and Chesterfield, packed with fascinating shops and great eateries
- Stately homes that have been the inspiration for our own cottages, such as Haddon, Hardwick, and Chatsworth
- Plenty of adrenaline-pumping outdoor pursuits in the nearby Peak District, like walking, cycling, and climbing

You'll find all this - and much more - right on your doorstep when you stay at Darwin Lake!